

CNC INDEX TABLE DC

CNC INDEX TABLE

- ◆ High accuracy and stable indexing accuracy.
- ◆ High rigidity and allows heavy loads.
- ◆ Can be operated by single axis controller.
- ◆ With 3 pcs hirth coupling, table will not lift during rotation.



Model No. : DC-320

CNC Index Table
Table Dia.

CNC ROTARY/
INDEX TABLE

Item/Model No.		DC-250	DC-320	DC-400	DC-500	
Diameter of Table	mm/inch	φ 250/9.84	φ 320/12.60	φ 400/15.75	φ 500/19.69	
Diameter of Thru-hole	mm/inch	φ 36/1.42	φ 60/2.36	φ 80/3.15	φ 130/5.12	
Center Height in Vertical	mm/inch	185/7.28	210/8.27	250/9.84	310/12.20	
Overall Hright in Vertical	mm/inch	322/12.68	395/15.55	460/18.11	570/22.44	
Overall Height in Horizontal	mm/inch	200/7.87	240/9.45	260/10.24	290/11.42	
Width of T Slot	mm	12 ^{H7}	14 ^{H7}	14 ^{H7}	18 ^{H7}	
Width of Guide Block	mm	18 ^{H7}	18 ^{H7}	18 ^{H7}	18 ^{H7}	
Servo Motor Type	FANUC	α 8i	α 12i	α 12i	α 22i	
	MITSUBISHI	HF-153	HF-203	HF-203	HF-353	
	SIEMENS	1FK7063	1FK7083	1FK7083	1FK7101	
	HEIDENHAIN	QSY116J	QSY155B	QSY155B	QSY155D	
Total Reduction Ratio		1:90	1:180	1:180	1:180	
MIN. Increment	72D	5	1	1	1	
	360D					deg.
MAX. Rotation Speed	RPM	22.2	11.1	11.1	11.1	
Indexing Accuracy	sec.	10"	10"	10"	10"	
Repeatability Accuracy	Bidirectional sec.	2"	2"	2"	2"	
Clamping Torque	(Hydraulic system:20kg/cm ²) kgf · m	250	275	300	325	
MAX. Work Load	Vertical	kg	125	200	350	400
	Horizontal	kg	300	400	600	700
MAX. Thrust Load	F	kgf	3500	4500	6000	7000
	FxL	kgf · m	140	200	400	450
Max. Machining Force	FxL	kgf · m	220	300	600	650
	N.W.	kg	110	250	325	380

◆ GANRO has right to revise the above specifications. We also can revise the specifications for customers' special requirement.

- ◆ 1. Up, backside and left cable outlet is available 2. Standard accessories: eye bolts, fixture blocks 3. Suitable tailstocks refer to p.52
4. Suitable controllers refer to p.56

DC-250

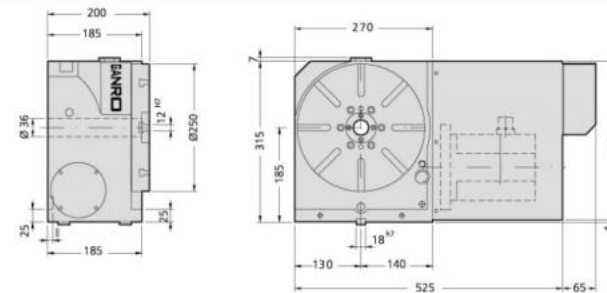

DC-320

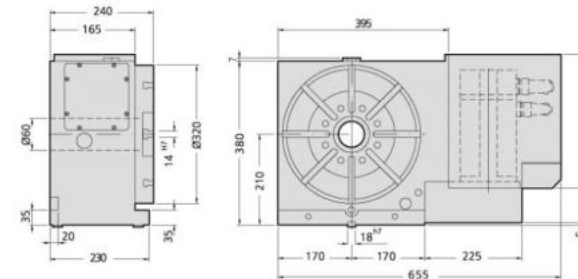

DC-400

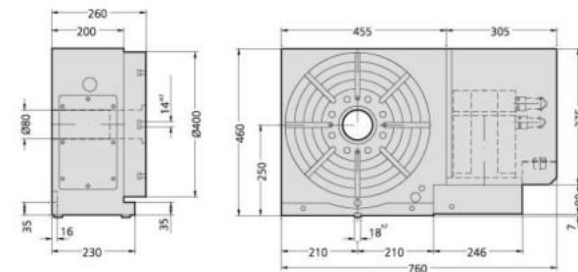

DC-500

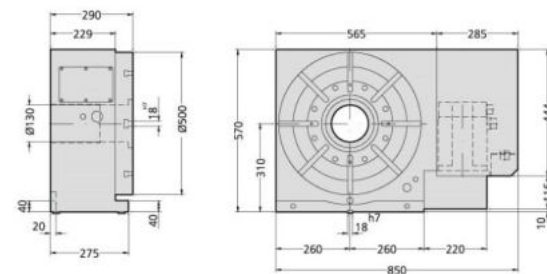

★ The size of motor metal sheet will change in accordance with real use of brand and model.